

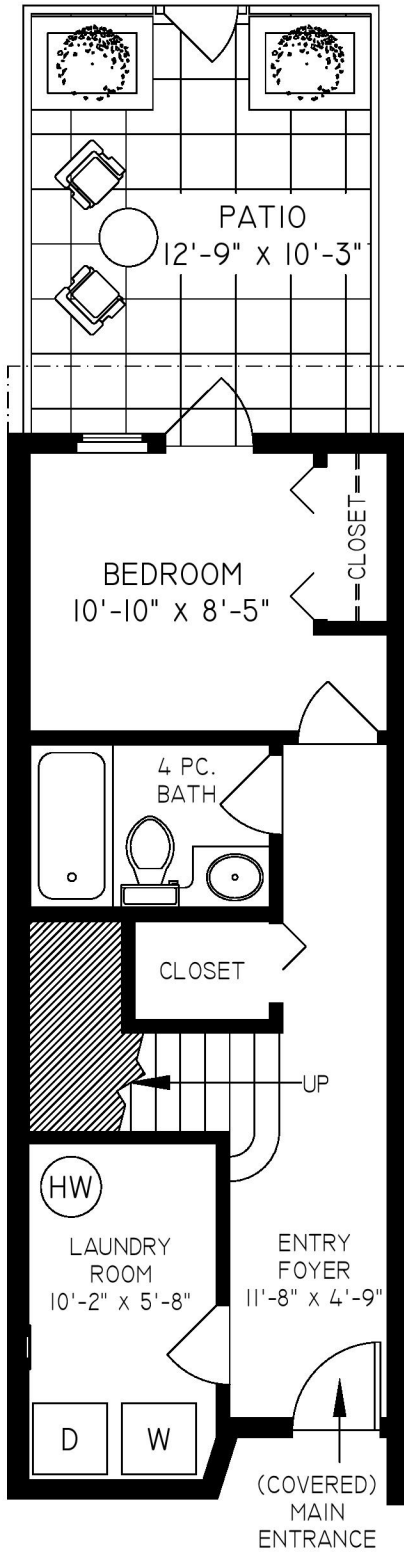

FIRST FLOOR
365 SQ. FT.

8'-0" CEILING HEIGHT



SECOND FLOOR
399 SQ. FT.

7'-9" - 8'-0" CEILING HEIGHTS

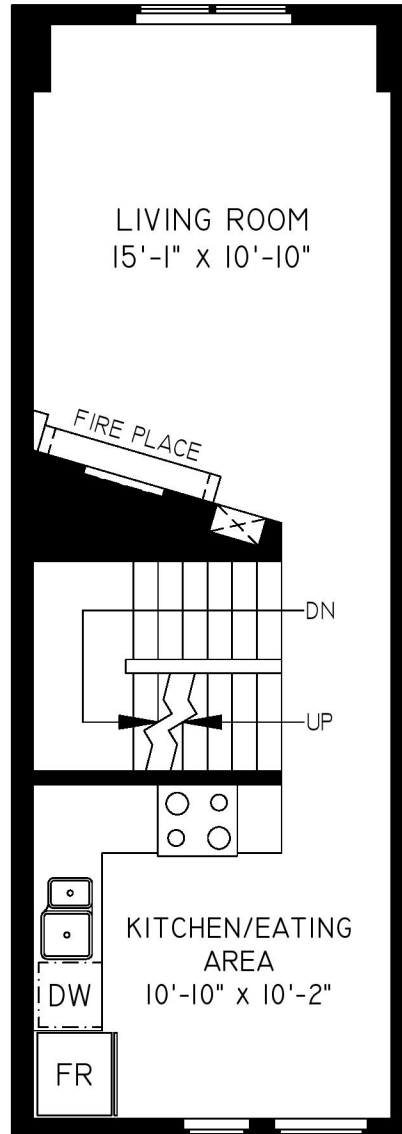

THIRD FLOOR
399 SQ. FT.

8'-0" - 10'-0" CEILING HEIGHTS

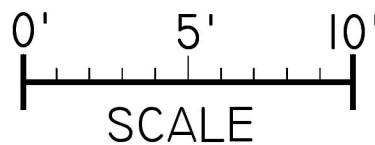
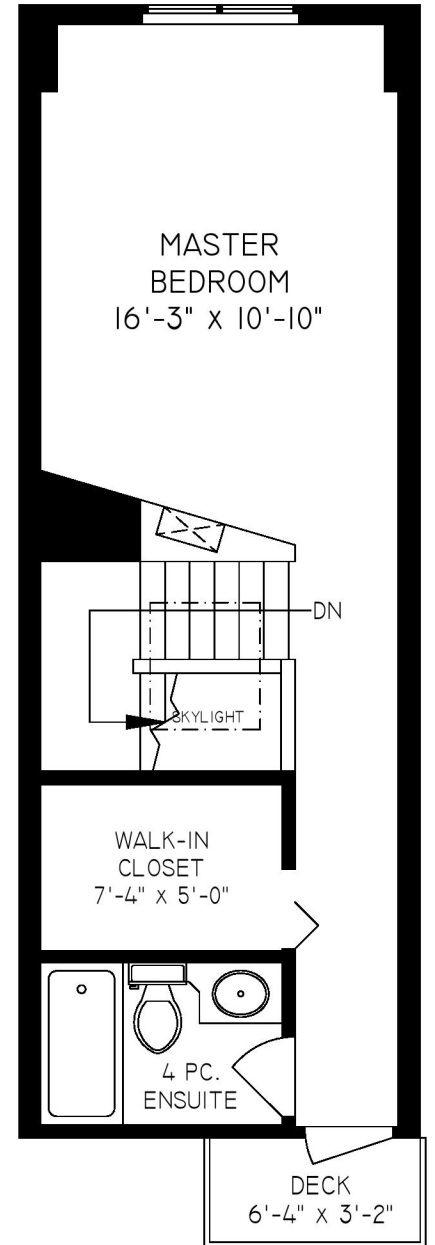

#13 - 888 W 16TH AVENUE, VANCOUVER		
FLOOR	AREA (SQ. FT.)	
	FINISHED	DECK/PATIO
FIRST	365	140
SECOND	399	-
THIRD	399	20
TOTAL	1163	160

THE REPRESENTED FLOOR PLANS ARE NOT SUITABLE FOR CONSTRUCTION/ARCHITECTURAL PURPOSES. EVERY EFFORT HAS BEEN MADE TO REPRESENT ALL DIMENSIONS ACCURATELY. E&O UNINSURED.